

UNO EVO / Roto Sensor Removal Tool

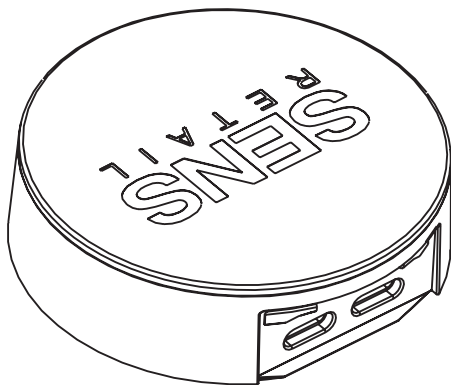

UNO EVO controller

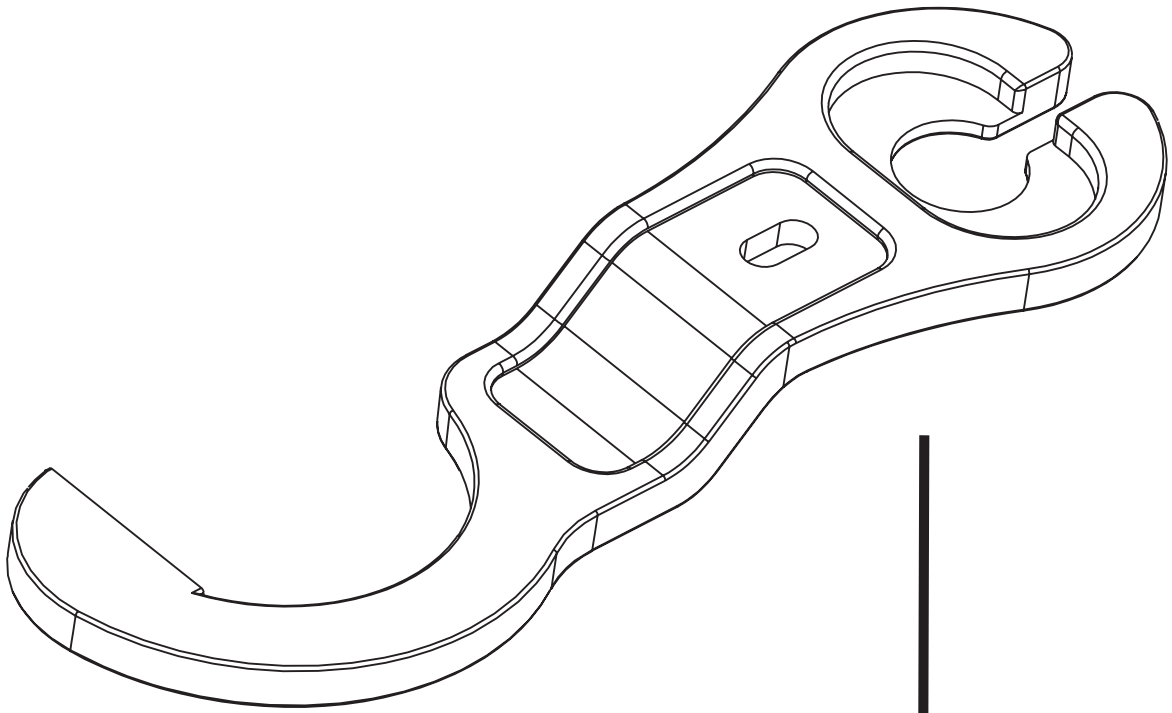
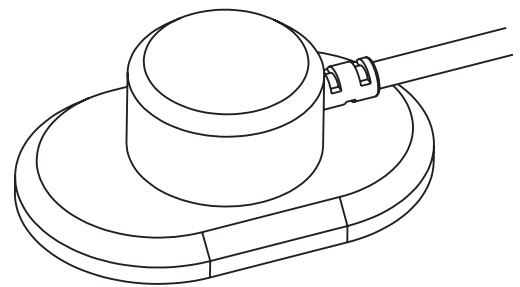

Roto Sensor

UNO EVO / Roto Sensor Removal Tool

Removing the UNO EVO

1. Loosen the screw from the UNO EVO controller.

2. Remove the cable blocker from the UNO EVO.

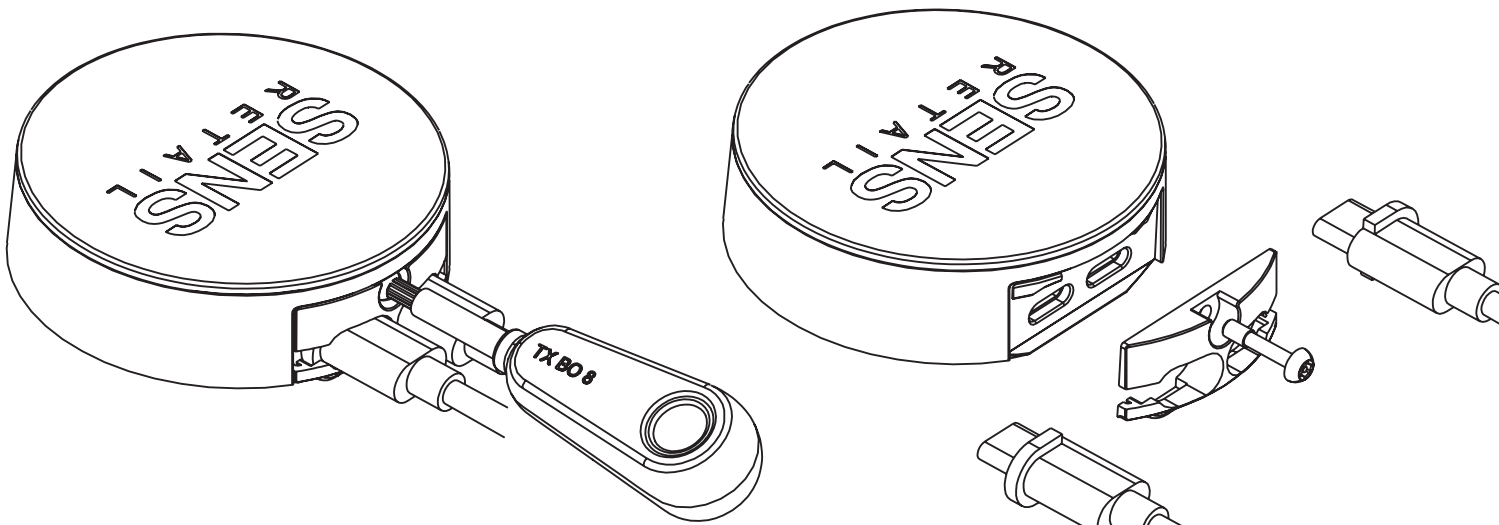

3. Place the tool on the UNO EVO controller as shown in the image and apply a light rotating force until the UNO EVO controller comes loose.

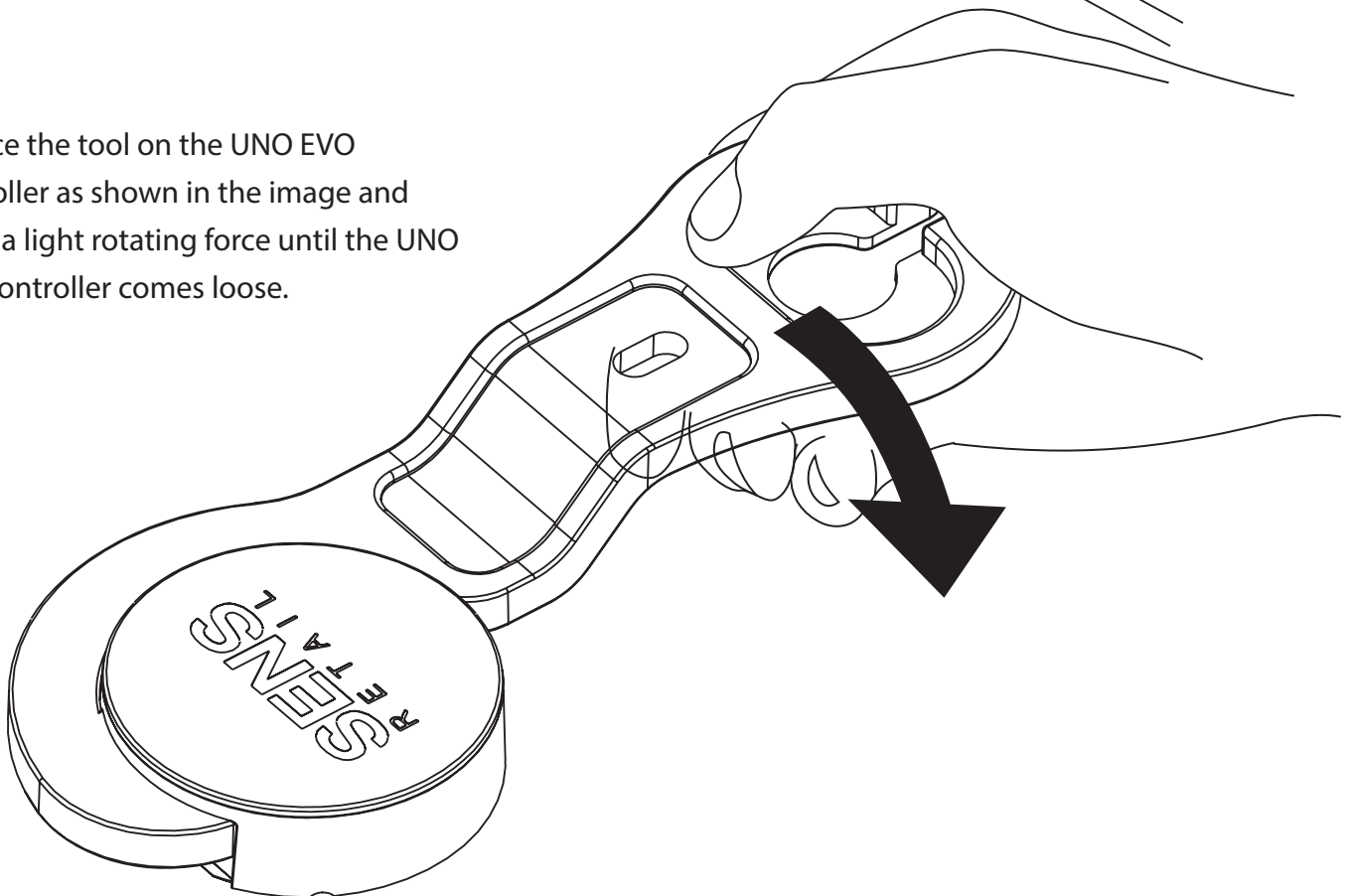

UNO EVO / Roto Sensor Removal Tool

Removing the Roto Sensor

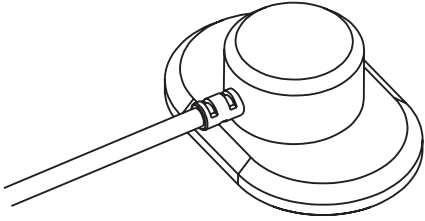

Place the Removal Tool over the Roto Sensor and apply a light rotating force until the Roto Sensor comes loose.

